

James Yeramian

From: Barbara Collins <barbara.collins@mrca.ca.gov>
Sent: Thursday, January 26, 2023 1:26 PM
To: James Yeramian
Subject: FW: Self nomination as MRCA's appointee to the SCPA
Attachments: Mountains Conservancy.pdf; MRCA letter of Support.pdf

-----Original Message-----

From: Zimble <peter@zimble.com>
Sent: Thursday, January 26, 2023 1:24 PM
To: Joseph T. Edmiston <joseph.edmiston@mrca.ca.gov>
Cc: Barbara Collins <barbara.collins@mrca.ca.gov>
Subject: Self nomination as MRCA's appointee to the SCPA

Hi Joe,

Please find attached my letter of self-nomination to be MRCA's appointee to the board of the Sullivan Canyon Preservation Association. Please confirm receipt. Also attached is a letter of support from the residents of Sullivan Canyon who bought the historic "Cliff May #3" house. Later this afternoon I'll send additional letters of support to include the ex-Chairman and CEO of United Cerebral Palsy of Southern California. I served on one of his boards for 11 years and we achieved some pretty incredible and very large scale outreach projects around Southern California and in many countries around the globe.

I look forward to the next steps in this process and, hopefully, to finally work together around the community outreach projects I have been so interested and involved in over the last two decades. I also look forward to learning more from you & your team about MRCA's mission at the SCPA.

Please let me know about next steps and thank you!

Best,

Peter Zimble

Joseph T. Edmiston, FAICP, Hon. ASLA
Executive Officer
Mountains Recreation & Conservation Authority

January 25, 2023

Dear Joe,

I'm writing you this note as a self-nomination to the Mountains Recreation & Conservation Authority to serve as the MRCA's appointee to the Sullivan Canyon Preservation Association.

When I learned of the newly vacated role, my first thought was the positive impact that could be achieved with a small, sustainable, community outreach program utilizing SCPA facilities. A program for the benefit of children with disabilities, people from disparate socio-economic backgrounds and others in need of a therapeutic environment. One that leverages the SCPA land for the benefit of the community and not just the neighborhood folks who can afford to live there with horses.

I am not a homeowner in Sullivan Canyon nor am I a member of the SCPA equestrian community. I strongly believe that these are two qualities which better serve the needs and mission of the MRCA at SCPA.

I am a 30-year resident of Los Angeles and, in addition to creating several satellite & wireless companies in the harshest of environments across the globe, I have dedicated the last 23 years in the service of children, adults and communities of people with physical and intellectual disabilities. I have served on the boards of United Cerebral Palsy of Southern California's "Wheels for Humanity" for eleven years as well as Best Buddies California as a Director and ultimately as its Chairman for three years. I also served as a committee member on the California Senate Select Committee on Autism & Related Disorders for several years. Each of these positions required creative, entrepreneurial thinking around community outreach, global outreach, inclusivity, advocacy and how to leverage the resources and core strengths of each organization to re-envision and advance their mission.

You may remember that you and I spoke several times in the past about community outreach that I have proposed on a larger scale on the west side of Los Angeles. When the State announced that it was shutting down 100 or so State Parks, I stepped up and created a two-year plan along with the funding to operate the WRSHP. I worked with Parks to understand how the funds could best serve their mission, the community and, most importantly from my perspective, how we could leverage the Park's land, trails, open space and equestrian facilities to provide a small multi-faceted program and harness the power of nature and animals. A program that would teach respect for animals and each other. After a tumultuous period at Parks, the State ultimately funded the continued operation of the WRSHP. Separately, I worked with the City of LA Recreation & Parks folks to create the same type of program at the Murphy Ranch. LAPD and LAFD were also involved and supportive. At the time, my "day job" kept me out of the country so it did not come to fruition. This is one example of a community outreach program, but there are certainly others to explore at SCPA.

All of this is very personal to me. My autistic son rode with the good folks at Ahead with Horses many years ago as well as the therapeutic riding program at Camp Josepho and other similar programs throughout the Los Angeles area. In fact, his mother and I attribute therapeutic riding and "social skills amongst animals" as the biggest contributor to enabling his expressive speech. The moment my son spoke his first sentence was around the age of 5, he was sitting in the back of my car and said "Dad, are we going to ride the horses today". I was stunned with a wave of parental relief and only then did I understand the power of animals and nature as therapy. Since then, I have been a relentless advocate. More recently, I have been talking to people at SCPA as well as Ahead with Horses about a pilot community outreach program at SCPA so the timing of your vacancy is fortuitous.

I have spent a lot of time in Sullivan Canyon over the past 15 years. A friend managed several properties in the Canyon and allowed my son and I to establish a wood shop at the "Wagner property" on Old Oak Rd. That property also happens to be Cliff May #3.

You may have seen the “state park style” signs, which my son makes, around the neighborhood. The eighty-five properties in the Canyon and the historical value of the neighborhood became more interesting and important to me when I retired from international communications and became a realtor. Today, I do my small part to retain the historical significance of the Canyon and preserve Cliff May’s vision and aesthetic.

The other important and unique aspect of the Sullivan Canyon magic is its equestrian zoning. Los Angeles County has lost too many equestrian zoned neighborhoods and properties to development posing as progress. Sullivan Canyon’s equestrian lifestyle along with its architectural and historical importance must be preserved.

I realize that my candidacy for this position does not follow SCPA’s traditional path. I believe that an independent, non-resident member of the board with extensive business and outreach experience would be an important asset. I also understand that there is a balance to be achieved between any SCPA community outreach program and the privacy of the residents.

SCPA has the ability to provide an exciting outdoor, safe and nurturing environment for people in need who don’t have access to this type of setting. A pilot SCPA outreach program with exposure to animals and nature would provide people with all types of challenges, whether they be emotional, intellectual, physical or economic, the opportunity to gain autonomy, self-reliance, self-worth and create learning experiences that would otherwise be unavailable. These are the benefits SCPA should be thinking about rather than keeping the open space exclusive to its residents. In fact, I have had many conversations with Sullivan Canyon residents who would welcome and be supportive of this new approach.

With that said, I’d like to throw my hat of “unique perspective of entrepreneurship and community “ into the ring for this position. My focus will be different than the homeowners and equestrians, but it is my strong belief that the SCPA board would benefit from a fresh, empathetic and community-based focus.

I look forward to chatting with you and your staff about how best to serve the MRCA and its interests in the SCPA.

Best,

Peter Zimble

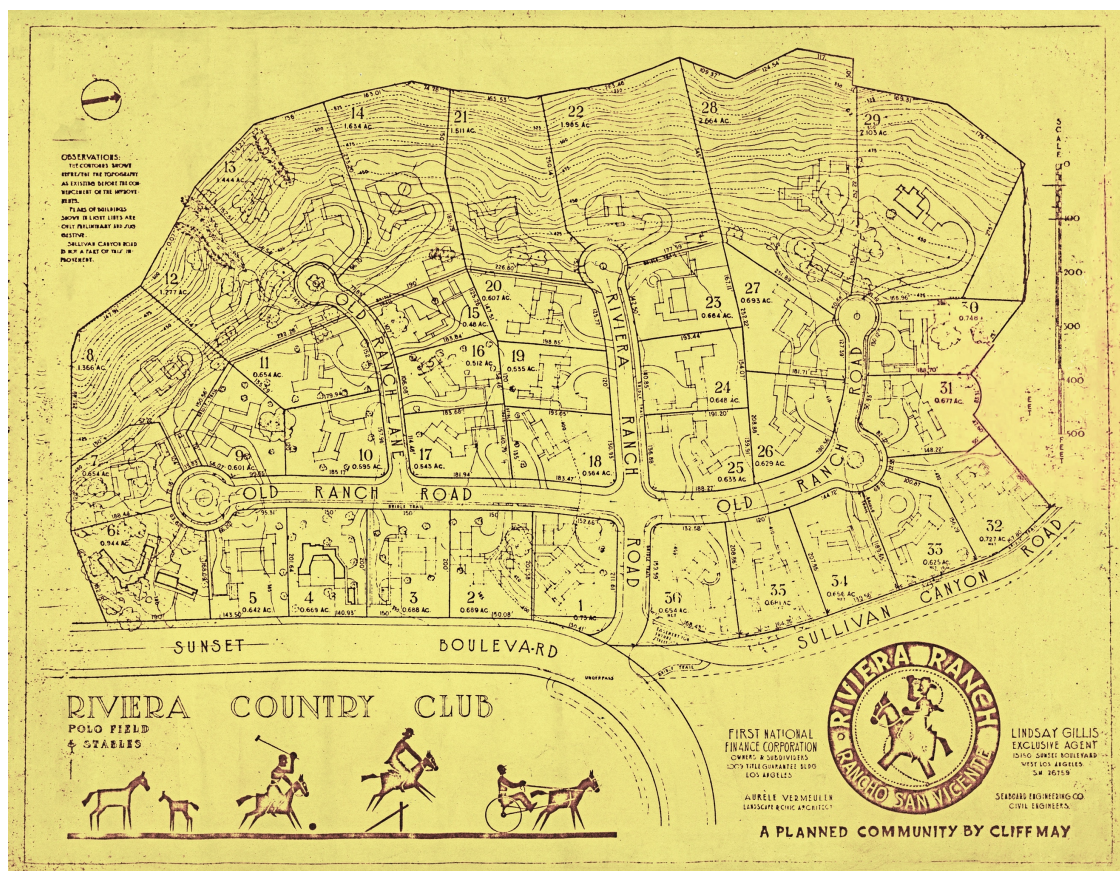

Joe Edmiston
Executive Officer
Mountains Recreation & Conservation Authority

September 25, 2023

Dear Joe,

I am writing this letter in support of Peter Zimble's application to the MRCA as your appointee to the Sullivan Canyon Preservation Association. I met Peter in 2009 when we were both serving on the California Senate Select Committee for Autism & Related Disorders. At the time, I was the Chairman & CEO of United Cerebral Palsy of Southern California (UCP), a position I held for thirty-eight years.

Initially, I was impressed by Peter's international entrepreneurial ventures. At the time, he had started commuting to Havana for his new company to bring Internet to the Cuban people. A "democracy through information" approach. We became fast friends and he told me about the 110 or so other countries he had provided Internet services to, but it wasn't just internet. He worked with foreign governments, their ministries and their in-country programs to identify how his company's Internet services could create new in-country opportunities. As an example, Peter guided his company to connect all of the schools and hospitals in Iraq bringing them connectivity for the first time. This completely changed the way schools at every level of education were able to teach and enabled telemedicine for hospitals and health clinics.

I asked Peter to become a Director on UCP's "Wheels For Humanity". This organization provided specialized wheelchairs to people with physical disabilities in dozens of countries around the world. I was certain Peter's relationships overseas at the highest levels would benefit our organization. During the 11 years he served on our board, Peter was a vocal and insightful member whose creative thinking and fund-raising efforts were an enormous contribution to the organization. Eventually, Peter brought to fruition the "mission" he and I first talked about, funding and delivering custom fitted wheelchairs to Cuba. Capturing Peter's efforts in that one sentence does not do justice to the three years of relentless political maneuvering and advocacy at the U.S. Departments of State, Treasury and Commerce. This was done simultaneously with his efforts at the Cuban government and their Ministry of Health. The fruits of his labor paid off and, together with a team of therapists, we flew to Cuba, unloaded two hundred wheelchairs at a school for children with special needs on the outskirts of Havana and each child received a custom fitted wheelchair.

Peter's tenacity and dedication to people in his own backyard as well as around the globe speaks for itself. He would be an enormous asset to the MRCA's endeavors towards community outreach in the Los Angeles area.

Warmly,

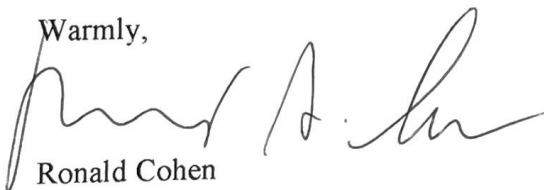

Ronald Cohen

Joe Edmiston
Executive Officer
Mountains Recreation & Conservation Authority

Dear Mr. Edmiston:

I am a homeowner in Sullivan Canyon and am writing to highly recommend Peter Zimble as the MRCA appointee to the Sullivan Canyon Preservation Association board. We have had the pleasure of knowing Peter for several years, first as a realtor and then, more importantly as a friend.

My husband and I bought the historically landmarked property known as "Cliff May #3" and are undergoing a studs up renovation. The property has been written about as "the most important example of Cliff May architecture in the country". Peter's deep knowledge and commitment to the properties in Sullivan Canyon, his guidance regarding the City's Office of Historical Preservation, historical and city ordinances and his pleasant and friendly personality have made our journey at this property a complete pleasure. I cannot emphasize enough on the benefits that Peter continues to bring to the table.

Peter also has a personal connection to Sullivan Canyon and has spent a lot of time in the neighborhood over the past many years. Before buying our property, we were happy to see that Peter had set up a wood shop for his autistic son to make wooden signs for the neighborhood and beyond. We were thrilled to let his son stay on at our property after we bought it and are touched by Peter's never-ending work to help his son and others with disabilities in the community.

What sets Peter apart is his passion for others and the public good. Peter is deeply committed to community service and has a proven track record with many different non-profit organizations. If there is a community outreach program that our little neighborhood can participate in, there is no one better qualified to spearhead it than Peter.

In conclusion, I highly recommend Peter Zimble for this position. Not only am I confident that he will exceed your expectations, I am confident that Peter would be a solid and independent voice for Sullivan Canyon and its community outreach.

Sincerely,

Marjan & Fred Mir
1500 Old Oak Rd.