

MOUNTAINS RECREATION AND CONSERVATION AUTHORITY

July 3, 2013 – Agenda Item _____

ENGINEER'S REPORT

MOUNTAINS RECREATION AND CONSERVATION AUTHORITY Santa Monica Mountains Open Space Preservation Assessment District No. 1 Los Angeles

AMENDED ASSESSMENT Amending Assessment Nos:

2274021030	2427008046	4362013021	4383006050	5569037023
2274022050	2428014018	4362013022	4386001008	5570009038
2274027004	2428024031	4369009007	5551016173	5572003015
2274027005	2429004047	4370023044	5555028017	5572004037
2279009024	2429022033	4370024032	5556001031	5572004038
2279014022	4352004016	4370024034	5556002031	5572022012
2279032044	4352010059	4371030030	5556002032	5575013037
2279032045	4355018052	4371030031	5556016051	5577027038
2376006019	4355019065	4377002039	5556017031	5577027040
2376016033	4355019066	4378003023	5558028040	5579030030
2376017027	4356019021	4380017066	5563002039	5582016029
2377003030	4357007020	4380019038	5564025040	5582016030
2385016029	4358008027	4383001036	5565022033	5585002039
2425008026	4362003038			

Pursuant to A Resolution Ordering the Making of Amended Assessments Under Part 10 of Division 10 of the California Streets and Highways Code, adopted by the Governing Board of Directors of the Mountains Recreation and Conservation Authority (the "Authority"), the undersigned does hereby apportion the assessments heretofore levied by the Board in its proceedings in and for the captioned assessment district because of divisions, mergers or other changes with respect to the original lots, pieces and parcels of and within said assessment district which have occurred since the levy of such assessments.

This report consists of the attached apportioned Amended Assessments, including the costs of apportionment not otherwise paid by the owners of record of the changed parcels and an amended assessment diagram relating to the changed parcels, which Amended Diagram refers to the original recorded assessment diagram for the assessment district.

Respectfully submitted this 24th day of May 2013



SCI Consulting Group

A handwritten signature in blue ink that reads "John W. Bliss". The signature is written in a cursive style and is positioned above a horizontal line.

By: _____
John W. Bliss, License No. C052091

EXHIBIT A

**MOUNTAINS RECREATION AND CONSERVATION AUTHORITY
Santa Monica Mountains Open Space Preservation Assessment District No. 1
Los Angeles**

Original Assessor's Parcel Numbers:	Original Assessment Amount	Unpaid Assessment	New Assessment Number	New Assessor Parcel Number(s)	Percentage of Original Assessment	Original Assessment Apportioned	Unpaid Assessment Apportioned	Cost of Apportionment	Property Owner's Name
2274021016; 2274021021	844.53	641.18	2274021030	2274-021-030	100.00 %	844.53	641.18	0.00	ADAMS WESLEY & JEANETTE
2274022047	563.02	427.45	2274022050	2274-022-050	100.00 %	563.02	427.45	0.00	PETERSEN KRISTIN P & MATTHEW
2274027003	563.02	427.45	2274027004	2274-027-004	50.00 %	281.51	213.73	0.00	THE BUCKLEY SCHOOL
2274027003	563.02	427.45	2274027005	2274-027-005	50.00 %	281.51	213.73	0.00	THE BUCKLEY SCHOOL
2279009005	563.02	427.45	2279009024	2279-009-024	100.00 %	563.02	427.45	0.00	MARINO MARY J
2279014012	563.02	427.45	2279014022	2279-014-022	100.00 %	563.02	427.45	0.00	OLAH GEORGE J & SALLY M
2279032033	563.02	427.45	2279032044	2279-032-044	100.00 %	563.02	427.45	0.00	TERINO TARA E
2279032017	563.02	427.45	2279032045	2279-032-045	100.00 %	563.02	427.45	0.00	GITTELSON ELLEN C
2376005001; 2376006016; 2376006018	1126.04	854.90	2376006019	2376-006-019	100.00 %	1126.04	854.90	0.00	TRUGMAN MARK P
2376016019	563.02	427.45	2376016033	2376-016-033	100.00 %	563.02	427.45	0.00	FIDELER LOUIS III
2376017022	281.51	213.73	2376017027	2376-017-027	100.00 %	281.51	213.73	0.00	PRETTY GOOD PROPERTIES LLC

EXHIBIT A

**MOUNTAINS RECREATION AND CONSERVATION AUTHORITY
Santa Monica Mountains Open Space Preservation Assessment District No. 1
Los Angeles**

Original Assessor's Parcel Numbers:	Original Assessment Amount	Unpaid Assessment	New Assessment Number	New Assessor Parcel Number(s)	Percentage of Original Assessment	Original Assessment Apportioned	Unpaid Assessment Apportioned	Cost of Apportionment	Property Owner's Name
2377003018	281.51	213.73	2377003030	2377-003-030	100.00 %	281.51	213.73	0.00	ARONOFF KENNETH D
2385016027	563.02	427.45	2385016029	2385-016-029	100.00 %	563.02	427.45	0.00	MAHDESIAN MICHAEL & NATALIE
2425008007; 2425008008; 2425008009; 2425008010	1407.55	1068.63	2425008026	2425-008-026	100.00 %	1407.55	1068.63	0.00	BUSHALA GEORGE & SYLVIA
2427008010	563.02	427.45	2427008046	2427-008-046	100.00 %	563.02	427.45	0.00	PAPILE PAUL
2428010036; 2428014001	844.53	641.18	2428014018	2428-014-018	100.00 %	844.53	641.18	0.00	HARROLD STEVEN J
2428024004; 2428024005; 2428024006	1126.04	854.90	2428024031	2428-024-031	100.00 %	1126.04	854.90	0.00	VANDORA STEVEN E
2429004044; 2429005020	844.53	641.18	2429004047	2429-004-047	100.00 %	844.53	641.18	0.00	KIERNAN PETER A & MEEGAN
2429022031	281.51	213.73	2429022033	2429-022-033	100.00 %	281.51	213.73	0.00	CARTER EUGENE
4352004014	563.02	427.45	4352004016	4352-004-016	100.00 %	563.02	427.45	0.00	1655 GILCREST INVESTMENT LP
4352001030	563.02	427.45	4352010059	4352-010-059	100.00 %	563.02	427.45	0.00	CARTER EUGENE J
4355018026	563.02	427.45	4355018052	4355-018-052	100.00 %	563.02	427.45	0.00	WILKINSON HUTTON J & RUTH

EXHIBIT A

**MOUNTAINS RECREATION AND CONSERVATION AUTHORITY
Santa Monica Mountains Open Space Preservation Assessment District No. 1
Los Angeles**

Original Assessor's Parcel Numbers:	Original Assessment Amount	Unpaid Assessment	New Assessment Number	New Assessor Parcel Number(s)	Percentage of Original Assessment	Original Assessment Apportioned	Unpaid Assessment Apportioned	Cost of Apportionment	Property Owner's Name
4355019043; 4355019044	563.02	427.45	4355019065	4355-019-065	100.00 %	563.02	427.45	0.00	JASMN HOLDING LLC
4355019037; 4355019044	844.53	641.18	4355019066	4355-019-066	100.00 %	844.53	641.18	0.00	BAUDIT JACQUELINE M
4356019011; 4356019012	563.02	427.45	4356019021	4356-019-021	100.00 %	563.02	427.45	0.00	AMBROSINO MARIE
4357007018; 0357007019	844.53	641.18	4357007020	4357-007-020	100.00 %	844.53	641.18	0.00	MANGO BENEDICT CANYON LLC
4358008017; 4358008018	563.02	427.45	4358008027	4358-008-027	100.00 %	563.02	427.45	0.00	ORDIN LANCE J
4362003009	563.02	427.45	4362003038	4362-003-038	100.00 %	563.02	427.45	0.00	PERUGINA LLC
4362016015	281.51	213.73	4362013021	4362-013-021	50.00 %	140.76	106.86	0.00	M AND A GABAE
4362016015	281.51	213.73	4362013022	4362-013-022	50.00 %	140.76	106.86	0.00	M AND A GABAE
4369009006; 4369016005; 4369016007; 4369017009	844.53	641.18	4369009007	4369-009-007	100.00 %	844.53	641.18	0.00	CHALON HOLDINGS LLC
4370023021	563.02	427.45	4370023044	4370-023-044	100.00 %	563.02	427.45	0.00	PINK TILLMAN JR & MIRIAM E
4370024031	1407.55	1068.63	4370024032	4370-024-032	100.00 %	1407.55	1068.63	0.00	ECP ACQUISITIONS LLC

EXHIBIT A

**MOUNTAINS RECREATION AND CONSERVATION AUTHORITY
Santa Monica Mountains Open Space Preservation Assessment District No. 1
Los Angeles**

Original Assessor's Parcel Numbers:	Original Assessment Amount	Unpaid Assessment	New Assessment Number	New Assessor Parcel Number(s)	Percentage of Original Assessment	Original Assessment Apportioned	Unpaid Assessment Apportioned	Cost of Apportionment	Property Owner's Name
4370024021	281.51	213.73	4370024034	4370-024-034	100.00 %	281.51	213.73	0.00	ECP ACQUISITIONS LLC
4371030010	563.02	427.45	4371030030	4371-030-030	50.00 %	281.51	213.73	0.00	ABRISHAMI ELIAS
4371030010	563.02	427.45	4371030031	4371-030-031	50.00 %	281.51	213.73	0.00	TREND CAPITAL GROUP INC
4377002036; 4377002037	563.02	427.45	4377002039	4377-002-039	100.00 %	563.02	427.45	0.00	FORTEEN HUNDRED LINDA FLORA LLC
4378003022	281.51	213.73	4378003023	4378-003-023	100.00 %	281.51	213.73	0.00	ARI BEL AIR LLC
4380017042	563.02	427.45	4380017066	4380-017-066	100.00 %	563.02	427.45	0.00	CALOF GRANT & GILLIAN
4380019030; 4380019034	844.53	641.18	4380019038	4380-019-038	100.00 %	844.53	641.18	0.00	ELTERMAN BRADLEY I
4382014011; 4383001032	844.53	641.18	4383001036	4383-001-036	100.00 %	844.53	641.18	0.00	GATINS JOHN
4383006009; 4383006010	563.02	427.45	4383006050	4383-006-050	100.00 %	563.02	427.45	0.00	PATTERSON CASONDRA
4386001005; 4386001006	844.53	641.18	4386001008	4386-001-008	100.00 %	844.53	641.18	0.00	ILIEV YOURIY V & SHANNON R
5551016002; 5551016003	8411.52	6386.10	5551016173	5551-016-173	100.00 %	8411.52	6386.10	0.00	CLG HOLLYWOOD LLC

EXHIBIT A

**MOUNTAINS RECREATION AND CONSERVATION AUTHORITY
Santa Monica Mountains Open Space Preservation Assessment District No. 1
Los Angeles**

Original Assessor's Parcel Numbers:	Original Assessment Amount	Unpaid Assessment	New Assessment Number	New Assessor Parcel Number(s)	Percentage of Original Assessment	Original Assessment Apportioned	Unpaid Assessment Apportioned	Cost of Apportionment	Property Owner's Name
5556029001	563.02	427.45	5556028017	5555-028-017	100.00 %	563.02	427.45	0.00	LEVIN SAMUEL J
5556001025; 5556001026	844.53	641.18	5556001031	5556-001-031	100.00 %	844.53	641.18	0.00	WEITZ BENJAMIN D
5556002029	343.44	260.74	5556002031	5556-002-031	100.00 %	343.44	260.74	0.00	HALSEY KRISTIE C
5556002029	343.44	260.74	5556002032	5556-002-032	100.00 %	343.44	260.74	0.00	HALSEY KRISTIE C
5556015041; 5556016017; 5556016024	1126.04	854.90	5556016051	5556-016-051	100.00 %	1126.04	854.90	0.00	ZOHAR LLC
5556017022; 5556017023; 5556017024	1126.04	854.90	5556017031	5556-017-031	100.00 %	1126.04	854.90	0.00	ROBERTS JASON
5558028024	563.02	427.45	5558028040	5558-028-040	100.00 %	563.02	427.45	0.00	CLAFLIN JOHN
5563002008; 5563002009	844.53	641.18	5563002039	5563-002-039	100.00 %	844.53	641.18	0.00	HABIB MATTHEW W
5564025034; 5564025035	844.53	641.18	5564025040	5564-025-040	100.00 %	844.53	641.18	0.00	MYERS RONALD J
5565022002; 5565022003	563.02	427.45	5565022033	5565-022-033	100.00 %	563.02	427.45	0.00	PRIME MARIE HELENE
5569031008	563.02	427.45	5569037023	5569-037-023	100.00 %	563.02	427.45	0.00	DOUGLAS JOAN

EXHIBIT A

**MOUNTAINS RECREATION AND CONSERVATION AUTHORITY
Santa Monica Mountains Open Space Preservation Assessment District No. 1
Los Angeles**

Original Assessor's Parcel Numbers:	Original Assessment Amount	Unpaid Assessment	New Assessment Number	New Assessor Parcel Number(s)	Percentage of Original Assessment	Original Assessment Apportioned	Unpaid Assessment Apportioned	Cost of Apportionment	Property Owner's Name
5570009007; 5570009033	844.53	641.18	5570009038	5570-009-038	100.00 %	844.53	641.18	0.00	BOYD DOUGLAS C & LINDA
5572003013	563.02	427.45	5572003015	5572-003-015	100.00 %	563.02	427.45	0.00	HISEY W O
5572004013	281.51	213.73	5572004037	5572-004-037	100.00 %	281.51	213.73	0.00	ROMINSKE MICHAEL K
5572004029	563.02	427.45	5572004038	5572-004-038	100.00 %	563.02	427.45	0.00	GEORGE TRYAN
5572022006	563.02	427.45	5572022012	5572-022-012	100.00 %	563.02	427.45	0.00	BISHARAT FRANCES W
5575013019	563.02	427.45	5575013037	5575-013-037	100.00 %	563.02	427.45	0.00	SHIRLEY JACQUELINE A
5577027021; 5577027022	563.02	427.45	5577027038	5577-027-038	100.00 %	563.02	427.45	0.00	BUCK ROBERT V
5577027037	563.02	427.45	5577027040	5577-027-040	100.00 %	563.02	427.45	0.00	BUCK ROBERT V
5579003006; 5579003021	844.53	641.18	5579030030	5579-030-030	100.00 %	844.53	641.18	0.00	FISHER BETTY L
5582016022	563.02	427.45	5582016029	5582-016-029	100.00 %	563.02	427.45	0.00	CAIRNS JAMES R
5582016020; 5582016023	844.53	641.18	5582016030	5582-016-030	100.00 %	844.53	641.18	0.00	QUINN JEAN

EXHIBIT A

**MOUNTAINS RECREATION AND CONSERVATION AUTHORITY
 Santa Monica Mountains Open Space Preservation Assessment District No. 1
 Los Angeles**

Original Assessor's Parcel Numbers:	Original Assessment Amount	Unpaid Assessment	New Assessment Number	New Assessor Parcel Number(s)	Percentage of Original Assessment	Original Assessment Apportioned	Unpaid Assessment Apportioned	Cost of Apportionment	Property Owner's Name
5585002019; 5585002031	844.53	641.18	5585002039	5585-002-039	100.00 %	844.53	641.18	0.00	ROSNER LOUISE

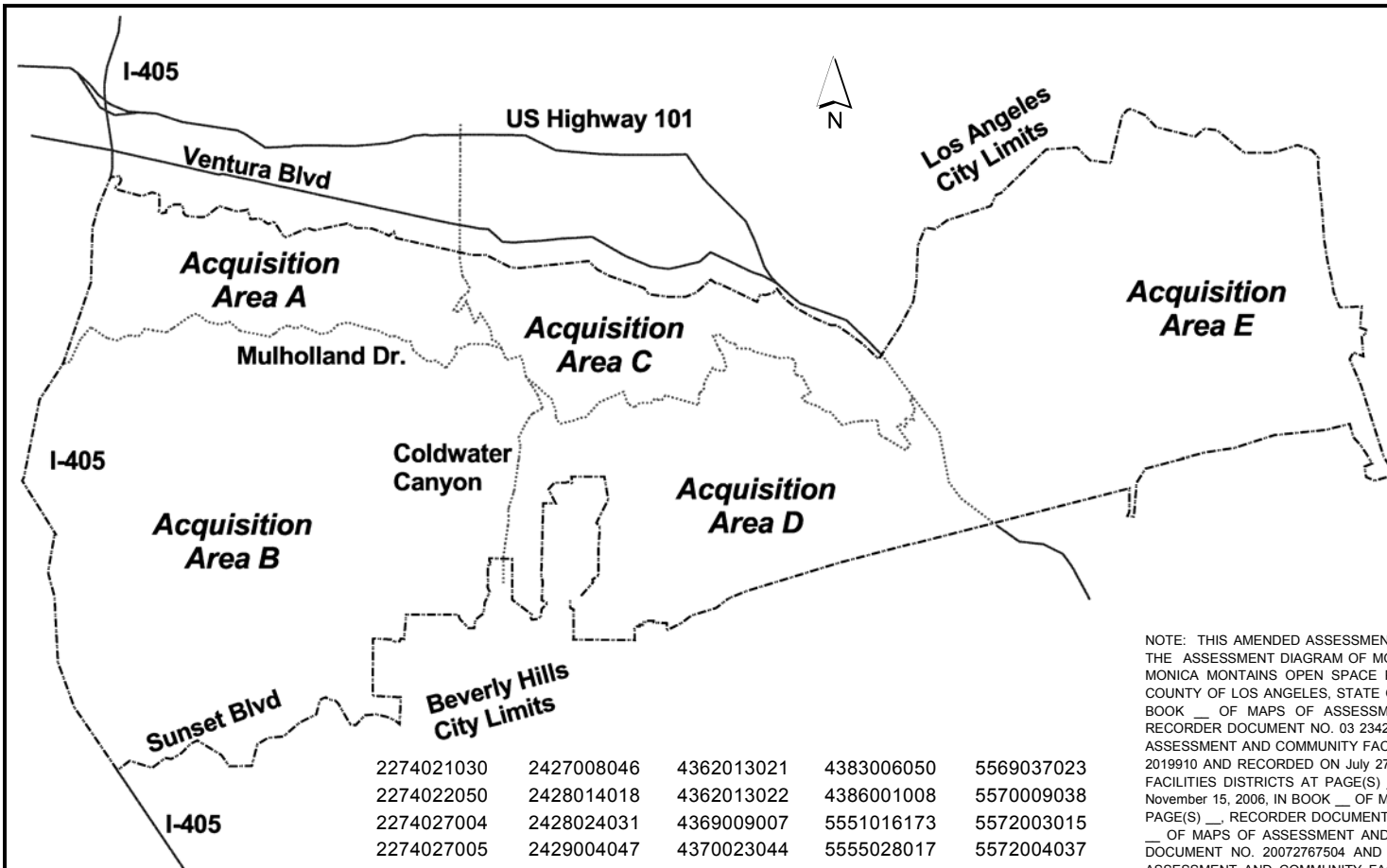

FILED IN THE OFFICE OF THE SECRETARY OF THE MOUNTAINS RECREATION AND CONSERVATION AUTHORITY THIS ____ DAY OF _____, 2013.

SECRETARY, MOUNTAINS RECREATION AND CONSERVATION AUTHORITY

RECORDED IN THE OFFICE OF THE ENGINEER OF MOUNTAINS RECREATION AND CONSERVATION AUTHORITY, THIS ____ DAY OF _____, 2013.

ENGINEER, MOUNTAINS RECREATION AND CONSERVATION AUTHORITY

FILED THIS ____ DAY OF _____, 2013, AT THE HOUR OF ____ O'CLOCK __.M., IN BOOK ____ OF MAPS OF ASSESSMENT AND COMMUNITY FACILITIES DISTRICTS AT PAGE(S) _____ IN THE OFFICE OF THE COUNTY RECORDER OF THE COUNTY OF LOS ANGELES, STATE OF CALIFORNIA.

COUNTY RECORDER, COUNTY OF LOS ANGELES

BY _____, DEPUTY

NOTE: THIS AMENDED ASSESSMENT DIAGRAM AMENDS ASSESSMENT NO(S).(SEE LIST TO LEFT) OF THE ASSESSMENT DIAGRAM OF MOUNTAINS RECREATION AND CONSERVATION AUTHORITY, SANTA MONICA MOUNTAINS OPEN SPACE PRESERVATION ASSESSMENT DISTRICT NO.1, LOS ANGELES, COUNTY OF LOS ANGELES, STATE OF CALIFORNIA, HERETOFORE RECORDED ON August 13, 2003, IN BOOK ____ OF MAPS OF ASSESSMENT AND COMMUNITY FACILITIES DISTRICTS AT PAGE(S) ___, RECORDER DOCUMENT NO. 03 2342862 AND RECORDED ON August 5, 2004, IN BOOK ____ OF MAPS OF ASSESSMENT AND COMMUNITY FACILITIES DISTRICTS AT PAGE(S) ___, RECORDER DOCUMENT NO. 04 2019910 AND RECORDED ON July 27, 2005, IN BOOK ____ OF MAPS OF ASSESSMENT AND COMMUNITY FACILITIES DISTRICTS AT PAGE(S) ___, RECORDER DOCUMENT NO. 05 1783696 AND RECORDED ON November 15, 2006, IN BOOK ____ OF MAPS OF ASSESSMENT AND COMMUNITY FACILITIES DISTRICTS AT PAGE(S) ___, RECORDER DOCUMENT NO. 06 2534570 AND RECORDED ON December 17, 2007, IN BOOK ____ OF MAPS OF ASSESSMENT AND COMMUNITY FACILITIES DISTRICTS AT PAGE(S) ___, RECORDER DOCUMENT NO. 20072767504 AND RECORDED ON September 10, 2008, IN BOOK ____ OF MAPS OF ASSESSMENT AND COMMUNITY FACILITIES DISTRICTS AT PAGE(S) ___, RECORDER DOCUMENT NO. 20081631981 AND RECORDED ON February 4, 2010, IN BOOK ____ OF MAPS OF ASSESSMENT AND COMMUNITY FACILITIES DISTRICTS AT PAGE(S) ___, RECORDER DOCUMENT NO. 20100150386 AND RECORDED ON December 13, 2010, IN BOOK ____ OF MAPS OF ASSESSMENT AND COMMUNITY FACILITIES DISTRICTS AT PAGE(S) ___, RECORDER DOCUMENT NO. 20101840824 AND RECORDED ON February 3, 2012, IN BOOK ____ OF MAPS OF ASSESSMENT AND COMMUNITY FACILITIES DISTRICTS AT PAGE(S) ___, RECORDER DOCUMENT NO. 20120201266 AND RECORDED ON _____, 2013, IN BOOK ____ OF MAPS OF ASSESSMENT AND COMMUNITY FACILITIES DISTRICTS AT PAGE(S) ___, RECORDER DOCUMENT NO. _____ INCLUSIVE IN THE OFFICE OF THE COUNTY RECORDER OF THE COUNTY OF LOS ANGELES, STATE OF CALIFORNIA.

2274021030	2427008046	4362013021	4383006050	5569037023
2274022050	2428014018	4362013022	4386001008	5570009038
2274027004	2428024031	4369009007	5551016173	5572003015
2274027005	2429004047	4370023044	5555028017	5572004037
2279009024	2429022033	4370024032	5556001031	5572004038
2279014022	4352004016	4370024034	5556002031	5572022012
2279032044	4352010059	4371030030	5556002032	5575013037
2279032045	4355018052	4371030031	5556016051	5577027038
2376006019	4355019065	4377002039	5556017031	5577027040
2376016033	4355019066	4378003023	5558028040	5579030030
2376017027	4356019021	4380017066	5563002039	5582016029
2377003030	4357007020	4380019038	5564025040	5582016030
2385016029	4358008027	4383001036	5565022033	5585002039
2425008026	4362003038			

- LEGEND**
- Assessment District Boundaries
 - Major Roads & Highways
 - Acquisition Area Boundaries

SCI Consulting Group
4745 Mangels Blvd
Fairfield, CA 94534
(707) 430-4300

EXHIBIT B
AMENDED ASSESSMENT DIAGRAM NO. 10
AMENDING ASSESSMENT NO(S).(SEE LIST TO LEFT)
MOUNTAINS RECREATION AND CONSERVATION AUTHORITY
Santa Monica Mountains Open Space Preservation
Assessment District No. 1, Los Angeles
County of Los Angeles, State of California