

50. ~~2836~~ 2836 ROSANNA ST LOS ANGELES CA 90039
51. ~~2836~~ 2836 ROSANNA ST. L.A. CA 90039
52. 2826 ROSANNA ST. L.A., CA 90039
53. Joseph Pineda 2827 ROSANNA ST. LA CA 90039
54. GONIA STEIN 2822 ROSANNA ST. 90039
55. Angelini B. Saldana 2827 Rosanna St.
56. ~~2837~~ 2837 Rossanna St L.A. CA. 90039
57. Carlos Cejeda 2837 Rossanna St LA CA 90039
58. Marisol Dechoa 2837 Rossanna St LA CA 90039
59. Brenda Barrios 2837 Rossanna St L.A. CA 90039
60. Melusamy Nicolas, 2845 1/2 Rossanna St L.A. CA 90039
61. Angelina N. 2845 1/2 Rosanna St. L.A. CA 90039
62. Clara Judan 2845 1/2 Rosanna St. L.A. CA 90039
63. Maclis Lopez 2846 Rosanna St. L.A. CA. 90039
64. Cecilia Lopez 2840 Rosanna St. LA, CA. 90039.
65. Yvonne Ayala 2907 Rosanna St. CA CA 90039
66. Nidia Z. Montano 2907 Rosanna St LA, CA 90039
67. ~~2907~~ 2907 1/2 Rosanna St /A 90039.
68. Shui Wong 2842 Rosanna St, L.A 90039
69. ~~2917~~ 2917 Rosanna St. LA 90039
70. Narciso Orozco 2907 1/2 Rosanna St Los Angeles
71. Rosanne Flores. 2906 1/2 Rosanna St. L.A 90039
72. JONATHAN B. UTULO 2827 ROSANNA ST
73. MARIAN B. UTULO 2827 ROSANNA ST

Monday, November 10, 2008: Meeting called by the Santa Monica Mountains and Conservancy at the Los Angeles River Center and Gardens to hear public testimony regarding the Marsh Park, Phase II plan. The Rosanna Street residents came in full force to voice out their opinions and concerns. Apparently, our voices fell on deaf ears and the planners and developers continued with the plan of having the entrance/exit at Rosanna Street.

2009 A skateboard park and a snake park were erected at the end of Marsh Street with parking spaces available adjacent to them. These parking areas can be utilized for the new park extension without disrupting the tranquility at Rosanna Street. Marsh Street has been used as the entrance to the Janel Glass Factory and the parks from whence they were put up.

2011 July 26, 2011 Rosanna Street residents were invited to a meeting at the Los Angeles River Center & Gardens by MRCA to get input regarding the design of the Marsh Park expansion. The plan presented to the residents was a totally different plan from the original plan presented to the group way back in 2002 which we voted on. The new plan has the Janel Glass Factory Building in it. Again, the residents voiced their opposition to the new plan that featured the park main entrance to be at Rosanna Street and parking spaces just beside the residences of Mary Whitecloud and Paul Ibusuki.

Copies of Mitigation Notes from Marta A. Segura, MPH, District-Field Director, Council District Office 13 regarding the Marsh Park Project received and on file.

It is the residents' wish to revisit the original plan voted on. It is also the residents' wish to not have any vehicular entrance at Rosanna Street only a walk-in entrance which would be opened and closed at specific times of the day as previously promised to us.



150 87 AUG 01 100 10:30

MOUNTAINS RECREATION & CONSERVATION AUTHORITY
Los Angeles River Center and Gardens
570 West Avenue Twenty-six, Suite 100
Los Angeles, California 90065
Phone (323) 221-9944 Fax (323) 221-9934

July 5, 2002

*Aug 8 6:30
Elysian Valley
2812 Newell*

Mary White Cloud
2919 Rosanna Street
Los Angeles, CA 90039

Reference: Marsh Street Park

Dear Ms. White Cloud,

It was good to speak with you on the phone this week about our park project at Marsh Street. I wanted to take this opportunity to introduce myself. While I am new to the MRCA, I am not new to park projects and work on the River. I have been involved with the River and open space issues in your community for almost 5 years. Between my work on parks with North East Trees and my efforts on bicycle and pedestrian issues in the community, I am very familiar with the challenges that face Elysian Valley.

As we discussed on the phone, we are working towards a park design solution that will be amendable to everyone. We are preparing for a working group meeting on July 25th at 6:30pm in the Los Feliz room at the River Center, 570 West Avenue 26. The park design will be discussed at that meeting and anyone interested in the process is welcome and encouraged attend.

Of course, a letter to the Council office would strengthen your views. The following points should be noted about the park:

- The project is part of State, County and City plans to create a river parkway system, and funding for the park comes from State Proposition 12 funds. These funds specifically exclude project elements of skateboard parks and playgrounds among others.
- The park will include picnic areas, access to the river and bike path, public art and many shade trees.
- Involvement from the entire community in this project is essential and immediately adjacent neighbors need to be part of this process.

It would be helpful for the Council office to receive some positive feedback from the community about the park project. The contact information for the Council office is:

Passive Park adjacent Neighbors

Office of City Councilmember Eric Garcetti
Council District 13
3525 Sunset Blvd.
Los Angeles, CA 90026
Attention: Heather Reppenning.
Telephone: (323) 913-4693

Thank you so much for your time and I look forward to meeting you in person

Sincerely,



Chuck Arnold
Project Analyst II
Mountains Recreation & Conservation Authority

Rosanna Street Neighborhood Alliance
Mary White Cloud
2919 Rosanna Street
Los Angeles, CA 90039

August 15, 2011 Time: 11:30 a.m.

RE: Meeting with Eric Garcetti
5500 Hollywood Blvd.
Los Angeles, CA 90028

In attendance:
Eric Garcetti
Councilmember, District 13
President, L.A. City Council

Anna Guerrero
Alejandra Marroquin

Rosanna Street Neighborhood Alliance
Mary Whitecloud
Kenny Webb
Paul and Sachi Ibusuki
Olga Alviar
Joanne Paratore
Cilgia Halprin

The meeting convened at 11:35 a.m. We presented our concerns to Mr. Garcetti by giving him a synopsis of the history of all that has transpired from 2002 when the Marsh Park project was conceptualized. We (RSNA) reiterated our opposition to the plan that has Rosanna Street as the main entrance to the proposed Marsh Park as presented to us during the meeting with MRCA along with a few of the residents of Rosanna Street on July 26, 2011. During this time, we (RSNA), conveyed our total disbelief that the original plan previously presented to us and approved by us, was thrown out, "missing". Instead, a new plan has been made by MRCA making Rosanna Street the main entrance to the park with a turnaround that included parking spaces adjacent to Mary Whiteclouds' and the Ibusuki's residences.

Anna took notes of our concerns namely:

- 1) Our opposition to the entrance of the park at Rosanna Street
- 2) Our request for an Environmental Impact Report
- 3) The lease details of Janel Glass Company

Anna Guerrero ended the meeting by scheduling a meeting for a walk-thru on Monday, August 15, 2011 @ 6:00 p.m. The meeting was to have representatives from the MRCA,

Barbara Romero and representativew from the RSNA with Anna Guerrero and and
Alejandra Marroquin from Eric Garcetti's office in attendance.
The meeting was adjourned at 12:30 p.m.



Good Land Realty Corporation

2330 FLETCHER DRIVE

LOS ANGELES, CALIFORNIA 90039-4053

(323) 661-0221 • (323) 661-6666 • FAX (323) 661-6949

September 27, 2011

Mary Whitecloud

Re: Elysian Valley Recreation Center
1811 Ripple Street
Los Angeles, CA 90039

Upon your concern and request, there are several issues relating to the value of your property if the City of Los Angeles Recreation & Parks erects a park and a parking lot to facilitate the park next to your property and neighboring homes on your block.

The first issue, your street Rosanna is not a through street. No traverse traffic only residential traffic, very Quiet Street especially at night. If the city erects a parking lot at the end of Rosanne, it can only add crime to happen more often. 12-4

The second issue is neighborhood security will be needed. More police present will be needed and more street lighting will be needed (your city taxes will be increased).

The third issue (last issue), home value. In reviewing home values in your immediate area: The first half of 2010' year a 2 bedrooms home with 1,079 square foot of living space, was valued at \$376,200., the second half of 2010 prices dropped -13% and the first half of 2011 it nearly dropped doubled -28%. 12-5

With increasing foreclosures and falling economy, home values downside & will be for some time and with the above two issue it will not help. The only solution is, the City to relocate the parking lot towards the rear of the park, away from residential homes.

I hope this is helpful for you and your community. If I can be any further assistance, please not hesitate to call.

Sincerely yours,

MILES LOO,
GOOD LAND REALTY CORPORATION

12/14/06 PJ
Pamela

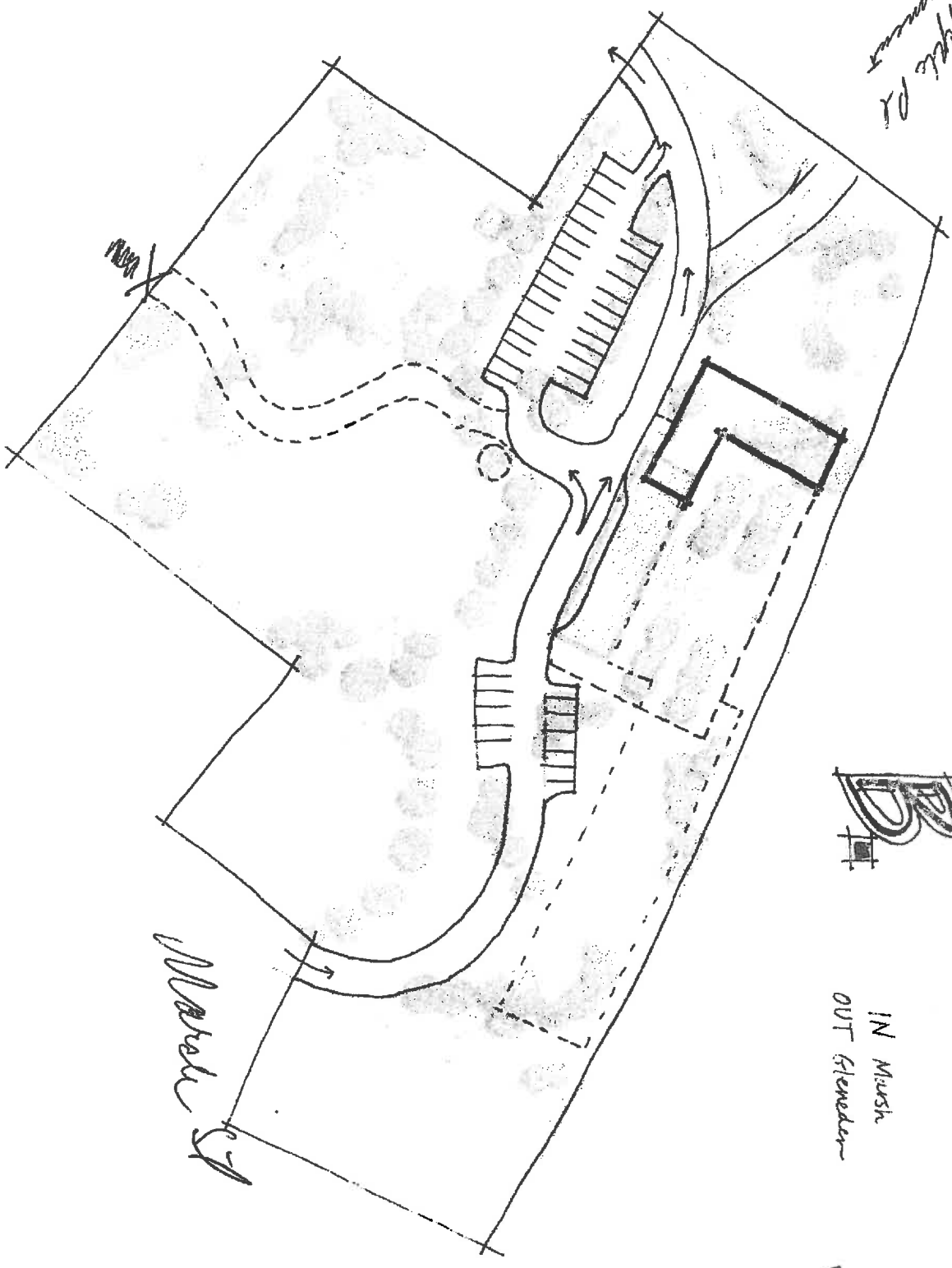

B

IN Marsh
OUT Elevator

12/14/06

Better Plan

Alviar, Josephine O.

From: jtparatore@aol.com
Sent: Wednesday, August 31, 2011 2:38 PM
To: Alviar, Josephine O.; sanpaulosan@aol.com; whiteclouddesigns@earthlink.net
Cc: rdd@juliolaw.com
Subject: Fwd: Re: Rosanna St Residents/Marsh Park

wh
Hello Everyone,
I'm forwarding to you my most recent email from Alejandra Marroquin, Garcetti's "Field Deputy".
Joanne Paratore
Project Manager, RSNA

-----Original Message-----

From: Alejandra Marroquin <alejandra.marroquin@lacity.org>
To: jtparatore <jtparatore@aol.com>
Cc: Melissa Guerrero <melissa.guerrero@mrca.ca.gov>; barbara.romero <barbara.romero@mrca.ca.gov>
Sent: Wed, Aug 31, 2011 12:27 pm
Subject: Re: Rosanna St Residents/Marsh Park

Hi Joanne,

Hope all is well and thanks for forwarding this email out to us.

I had also contacted Mary Whitecloud about this as she had called our office inquiring about the same thing. She had indicated to me that you both were wondering about the documents given that you had contacted the MRCA but had not received them.

After calling Melissa and Barbara, I was informed that the MRCA had in fact been granted permission to provide you with the documents by their lawyer. The one final thing that they needed was to get clearance from their Executive Director who was on vacation until this week. After hearing this update, I then called Mary and asked her to inform you about this.

Given this scenario, you should be receiving the documents from the MRCA once they have received clearance from their Executive Director. I have cc'd Melissa and Barbara in this email so that they can chime in in case I have missed anything.

Thanks Joanne and speak with you soon.

Best,

Alejandra

On Tue, Aug 30, 2011 at 9:50 AM, <jtparatore@aol.com> wrote:

8/31/2011

-----Original Message-----

From: jtparatore <jtparatore@aol.com>
To: Ana.Guerrero <Ana.Guerrero@lacity.org>
Sent: Tue, Aug 30, 2011 9:39 am
Subject: Rosanna St Residents/Marsh Park

Please forward to Mr. Garcetti, Thank You.

Good Morning Ana,

Hope you had a nice vacation,

Attached please find documents from the Rosanna Street Neighborhood Alliance of the last two meetings.

We await copies of the environmental plans that have been promised to us, and take this opportunity to remind your office of our request for a redesign that accomodates our needs with regards to the Marsh Park so proposed entrances to the park and locations of parking lots.

In addition, Mary Whitecloud has surveyed the land along the river and discovered that there are already 50 parking spaces available. She also observed that there are numerous unsightly parking lots along the river that are already in existence. Also found were an abundance of schrub and over growth that has been left unattended along the river banks and graffiti along the backsides of many buildings.

We thank you for taking the time to continue to review our numerous concerns.

Joanne Paratore
Project Manager
Rosanna Street Neighborhood Alliance

cc: Mary Whitecloud
Olga Alviar
Paul and Sachi Ibusuki
Elsa Flores

--
Alejandra Marroquin, Field Deputy
Council President, Eric Garcetti
Los Angeles City Council
5500 Hollywood Blvd.
Los Angeles, CA 90028
323-957-4500
Alejandra.Marroquin@lacity.org
Visit www.cd13.org



Tips to Protect Children from Environmental Risks

From: jparatore@aol.com
To: Kathleen Stewart/R9/USEPA/US@EPA
Date: 10/11/2011 12:30 AM
Subject: Rosanna St Residents/Marsh Park

Hello Katheen,
Thanks for getting in touch with me last week regarding Marsh Park and the plans for park extension at the end of Rosanna Street, LA 90039. As you know, I have also been contacted by David Thompson of the EPA.

For the past nine years we have been meeting with the MRCA, Mountains Recreation Conservation Authority, and our Councilman, Eric Garcetti. According to the "MRCA" a non profit organization, they own the land at the end of our street and are funded to build passive parks in Los Angeles.

The MRCA has invited us to meetings for the last nine years to view various possible plans to redevelop the land into a passive park at the end of Rosanna Street which would be an extensive of Marsh Park, the next street over. "Phase One" would have included the tear down of Janel Glass company, a large building in front of the river at the end of Rosanna Street. (all streets in this neighborhood dead end to the river). There were environmental reports done for the original Phase One project, which is no longer in existence.

Since then, we have heard the budget is smaller and they have aquired Sequas for their new "phases" which eliminates the tear down of Janel Glass, which they collect rent for, and build the park IN FRONT of a big old glass building. These plans include parking lots and an entrance at the end of our street. We oppose these these plans and continue to ask for a re-design at every meeting. There are other possibilities that they have not explored for parking such as 50 to 60 spaces already existing and entrances other than Rosanna. There are already two possible entrances beside the Marsh Street entrance from Ripple Place and Gleneden.

We are also concerned that the land in front of the glass building may be contaminated due to it's history and don't understand why the MRCA would build a small park on top of possibly contaminated land, which children will be playing on, in front of a big ugly building and put parking lots at the end of our street. There is also a history of gangs in this area and we would like to maintain the peaceful safe neighbor hood that we have developed over the past 40 years.

12-7

Thank You for your concern,
On behalf of the Rosanna Street Neighborhood Alliance,
Joanne Paratore



ROSANNA STREET NEIGHBORHOOD ALLIANCE
2919 Rosanna Street
Los Angeles, CA 90039

June 3, 2012

Eric Garcetti
Council Member
District 13 of the Los Angeles City Council
5500 Hollywood Blvd.
Los Angeles, CA 90028

Dear Mr. Garcetti,

A meeting was convened on May 29, 2012 at 6:30 p.m. at the residence of Mary Whitecloud and Kenny Webb located at Rosanna Street. In attendance were Anna Guerrero, Alejandra Marroquin and Oliver DelGado from your office and Mary Whitecloud, Kenny Webb, Paul and Sachi Ibusuki, Joanne Paratore, Elsa Palomino, Alex and Olga Alviar of the RSNA.

During this meeting, we were presented with a new plan for the proposed Marsh Park. There are several issues we would like you to address and if possible intervene on behalf of the residents of Rosanna Street with MRCA and they are the following:

1. The new plan will still have an entrance at Rosanna Street which they claim would only be used for maintenance crews. What guarantee can we have that that entrance would not be opened once the park is already in use? If it would only be for the maintenance crew, the entrance on Gleneden Street would suffice. We would not be able to stop anyone from opening up that entrance once the park is already in operation. We would rather have that entrance entirely closed off.
2. We were told that the parking spaces have been reduced from 50 to 42. We still do not see the logic of having that many parking spaces for a little park which would cater mostly to the residents of the area. The plan does not include any facilities that would be rented out for use as function halls, that parking spaces would necessitate that many parking spots in this park. Furthermore, the area has already an existing parking lot which is not in use by the Jennel Factory since the factory is not even on a 100% operational mode. It was claimed that the existing parking lot is not part of the Marsh Park plan. But don't you think that it would be more appropriate to use what is in existence already? This way, the green part of the park will be maximized and it would save MRCA a lot of money with the use of existing facilities in the area. Even if the proposed parking lot is about 35 ft away from the residences, it still does not warrant our approval because it really does not make any sense.

3. Most of the residents have lived here in the area for a long time. During that time, we have had the misfortune of having a lot of businesses in that lot which did not adhere to proper environmental maintenance. Because of this, we want to insist and demand that a more in depth environmental study be done on the area before the park can be constructed. No one is more impacted than anyone else in the construction of this park than the residents of Rosanna Street and the neighboring streets.

4. We would like to go back to the original plan of the park which we have voted on and agreed on way back in 2002. It looks like MRCA wants to push through with what they like disregarding the wishes of the community that the park would be catering to. From the looks of things, MRCA thinks that they can sugar coat their plan to appease us. We will not fall for it. For whatever reasons the MRCA have in pushing for this new plan, you will be guaranteed that we will fight it unless our wishes are heard and heeded.

The above points that we would like to be resolved warrant your undivided attention and assistance.

We would greatly appreciate the involvement you would have in this matter.

Sincerely,

Rosanna Street Neighborhood Alliance

Cc Mary Whitecloud
Kenny Webb
Paul and Sachi Ibusuki
Joanne Paratore
Juvenal and Elsa Flores
Alex

Rosanna Street Neighborhood Alliance
Mary Whitecloud
2919 Rosanna Street
L.A. CA 90039

August 18, 2011 Time: 06:00 p.m.

RE: Walk-thru meeting at the proposed Marsh Park

In attendance:

Barbara Romero, MRCA
Melissa Guerrero, MRCA
Anna Guerrero, Eric Garcetti's Office
Alejandra Marroquin, Eric Garcetti's Office

Rosanna Street Neighborhood Alliance
Mary Whitecloud
Kenny Webb
Paul Ibusuki
Olga Alviar
Joanne Paratore
Juvenal and Elsa Flores
Alex
Drew and Kurt Beckmeyer
Ashley

The meeting was convened at 6:00 at the gate by Rosanna Street leading to the proposed Marsh Park. MRCA personnel, Barbara Romero and Melissa Guerrero, marked the perimeters of the said turnaround and the parking spaces that are being proposed to show RSNA how far away from the residences the parking areas would be. We were also told by the MRCA that buffers, an 8' wall would be put up adjacent to Mary Whitecloud's and Paul Ibusuki's residences with trees planted all around the parking area.

RSNA reiterated their opposition to the entrance and the parking lots by Rosanna Street. The RSNA requested the MRCA provide the RSNA with Environmental Impact Report (EIR) and/or SEQAs conducted on the property as a prerequisite to building the park. MRCA affirmed that these reports are available and would provide RSNA copies of all reports conducted starting from Phase 1 to Phase 4.

12-9

Additional concerns of the RSNA:

1. We continually suggest an entrance from Ripple Place where there will be less impact on residents. There are only three houses on this street.
2. MRCA is to clean up the overgrown bushes/weeds on the property which are now becoming fire hazards.
3. The particulars of the lease that Janel Glass Company has with the MRCA.

12-10

The RSNA demanded a redesign accommodating our requests to remove the parking lots from the end of Rosanna Street along with drive-in entrance. Anna Guererro, from Eric Garcetti's Office adjourned the meeting promising to meet with RSNA again in about a month to talk about the pending issues of Marsh Park. She also promised the group that she will help us get the environmental reports that the RSNA is requesting.



ROSANNA STREET NEIGHBORHOOD ALLIANCE
2919 Rosanna Street
Los Angeles, CA 90039

June 4, 2012

Eric Garcetti
Councilmember
District Thirteen of the Los Angeles City Council
5500 Hollywood Boulevard
Los Angeles, CA 90028

Dear Mr. Garcetti,

On behalf of the Rosanna Street Neighborhood Alliance, we congratulate you on your bid for Mayor of Los Angeles. However, as our councilman, we need you help right now!

We are requesting you to hold MRCA accountable and make sure that Marsh Street Park is designed in a way that is acceptable to the residents. In the past ten years, we have attended meetings where we discussed and voted on designs for the park and were promised that there would be no entrance on Rosanna Street and now parking anywhere near the home owner's property.

We were shocked when MRCA came up with a design that included all of the things that we did not want and that no one had ever seen before, much less approved. We have met with members of your staff who seem to defer to MRCA and claim that they are powerless. However, we know for a fact that this is not true!

Furthermore, this is not a neighborhood council issue. We expect you, as our councilman, to exhibit your leadership on our behalf and step forward to support the residents' rights. We demand that the park is designed in the manner that we approved and were promised, which were no entrance and no parking lots by our homes. This is a small neighborhood park and there are already adequate parking spaces on the land. We are requesting a meeting with you at your earliest convenience.

Sincerely,

Mary Whitecloud
President of Rosanna Street Neighborhood Alliance

Camille Frigillana
2917 Rosanna Street
Los Angeles, California 90039
6/1/12

Eric Garcetti
Councilmember
District Thirteen of the Los Angeles City Council
5500 Hollywood Boulevard
Los Angeles, California 90028

Dear Mr. Garcetti,

My name is Camille Frigillana, and I am a high school student living in Elysian Valley. It has come to my attention that you intend to build a park entrance at the end of Rosanna Street, which is the street I live on. I am writing this letter because I do not agree with these plans. As a resident on this street, I feel like I should have a say as to what goes on in it and have a full understanding of what kind of changes are to take place in my neighborhood.

As I said before, I am a residence on Rosanna Street, and have been my whole life. Our street is very quiet and there is minimal traffic going through it because it is a dead- end street. However, this was not always the case in the past. Our street is a dead- end street because a glass company occupies the lot. Unfortunately, since it was a running factory, numerous trucks would come down our street late at night and into the early morning to pick up glass. The neighbors on our street, however, were able to convince the company to move its truck entrance to another street that did not have many people living on it.

12-11

Now, the people of Rosanna Street are faced with the challenge of the park entrance. Of course, we do not oppose the idea of the empty lot becoming a park. We oppose the fact that the entrance to this park will be located at the end of our street. By placing the entrance of this park, our homes will lose value, traffic will greatly increase, and trash left from party- goers and picnickers will be left for us to clean up. Also, gang activity will most likely increase on our street because local gang members can use the parking lot in the entrance as a place to deal drugs, put their graffiti on, and illicit violent behavior.

12-12

That is why, Mr. Garcetti, I am proposing a different plan that is a better solution and can benefit everyone. I propose that we move the park entrance to the already existing skate park located on Marsh Street, which is two blocks over. There is already a small parking lot available, and the little number of residences there are already used to the traffic. It is also a lot easier for people from different places to access this entrance because it is a wider street, and it is located closer to the freeway. If the park entrance is located there, then less people will be negatively affected, and more people would, instead, benefit from it.

I thank you, Mr. Garcetti, for taking the time to read my letter regarding the issue of the Rosanna street park entrance, and I hope you take my proposal into consideration when making your final decision.

Sincerely,

Camille Frigillana

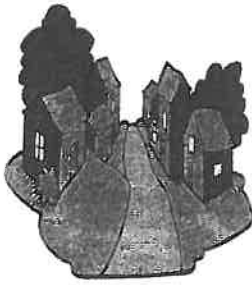

ROSANNA STREET NEIGHBORHOOD ALLIANCE
2919 Rosanna Street
Los Angeles, CA 90039

July 20, 2012

Eric Garcetti
Councilman District 13
5500 Hollywood Blvd.
Los Angeles, CA. 90029

Re: Marsh Park

Dear Mr. Garcetti,

We are following up on your commitment to check back in with the MRCA regarding our dissatisfaction and modifications they provided us with for Marsh Park.

Since MRCA owns Janel Glass Factory and the land surrounding it, we are confident the MRCA can create their own easement on their own property to allow for parking to continue there for the parks, as was the original version for the park for over ten years now. It will take a simple affidavit from them.

It is clear from the latest modified plan that MRCA never intends on creating an entrance off of Marsh Street. That is unacceptable and we believe we have been misled and misrepresented on this major issue.

We look forward to hearing back from you within one week on your commitment and to discuss these other points in greater detail.

On behalf of the Rosanna Street Neighborhood Alliance,
Mary Whitecloud
Kenny Webb
Paul Ibusuki
Sachi Ibusuki
Gary Ibusuki
Olga Alviar
Camille Alviar
Joanne Paratore
Elsa Flores
Juvenal Flores
Alex Gallo
Drew and Kurt Beckmeyer
Tiffin Roley
Ashley

cc: Alejandra Marroquin
cc: Anna Guerrero

12. Responses To Letter Packet containing chronology documents, Mary Whitecloud, August 1, 2012

Since the purpose of this document is to address the potential environmental effects of the project, responses are not provided herein to comments on the project, or it's design, as part of the MND. Project and design comments, questions and suggestions will be addressed outside the environmental process as part of the Board's project consideration. Any design comments, questions and suggestions included in the comment letter are hereby transmitted to the MRCA Board for their consideration. Responses are provided to the following environmental issues of comments in the commenter's letter:

Response

12-1 Three environmental assessments have been done for the project site. These reports document and evaluate the potential impacts of prior uses on the project site. They provide much of substantial evidence for the conclusions in the MND that potential hazardous materials impacts are either "less than significant" or can be reduced to "less than significant" through implementation of the specified mitigation measures. The three reports are:

1. A Phase I Environmental Assessment titled, Preliminary Environmental Assessment, Marsh Street Property, 2944 Gleneden Street, Los Angeles, California, prepared by CET Environmental Services, Inc., July 1998. (MND Reference 9, MND page 11).
2. A Phase II Environmental Assessment titled, Phase II Environmental Site Assessment Report 2960/2961 Marsh Street and 2940/2961 Rosanna Street, prepared by CAPE Environmental Management Inc, November 2000.
3. Summary Report: Pre-Demolition Bulk Asbestos and Lead-Based Paint Survey, Mountains Recreation and Conservation Authority – Gleneden Property, 2944 Gleneden Street, Los Angeles, CA 90039, prepared by SCA Environmental, Inc., September 2010. (MND Reference 7, MND page 11).

For more information, see Response to Comment 5-2.

The MND evaluates the potential impacts associated with the proposed project against the baseline of existing conditions as required by CEQA.