

# MOUNTAINS RECREATION AND CONSERVATION AUTHORITY

July 6, 2011 – Agenda Item \_\_\_\_\_

## ENGINEER'S REPORT

### MOUNTAINS RECREATION AND CONSERVATION AUTHORITY Santa Monica Mountains Open Space Preservation Assessment District No. 1 Los Angeles

#### AMENDED ASSESSMENT Amending Assessment Nos:

2274023033	2385009037	2428010049	4362017047	5558006030	5570006021
2274026006	2385017027	2428010050	4362017048	5558012027	5570036018
2275010030	2385023035	2428010051	4369036029	5560021029	5570038029
2277007026	2385023036	2428013019	4371001011	5560021030	5571001027
2369009030	2385023037	2428028037	4371004022	5561019033	5572029058
2369009031	2385027034	2429020025	4377010019	5561021031	5572029059
2373020016	2386004013	4352009054	4377017018	5563015038	5572029060
2373022018	2386004014	4355011045	4377048019	5564028031	5572029061
2373022019	2386005052	4356008010	4380010030	5565016010	5572029062
2376015029	2386005053	4356016026	4383020024	5565028041	5572029063
2384015048	2428003052	4356016027	5549021037	5565031014	5579019036
2384015049	2428010045	4362009011	5556010042	5567022038	
2385004055	2428010047	4362015022	5556025018	5567025047	
2385004056	2428010048	4362017034	5556025019	5569036016	

Pursuant to A Resolution Ordering the Making of Amended Assessments Under Part 10 of Division 10 of the California Streets and Highways Code, adopted by the Governing Board of Directors of the Mountains Recreation and Conservation Authority (the "Authority"), the undersigned does hereby apportion the assessments heretofore levied by the Board in its proceedings in and for the captioned assessment district because of divisions, mergers or other changes with respect to the original lots, pieces and parcels of and within said assessment district which have occurred since the levy of such assessments.

This report consists of the attached apportioned Amended Assessments, including the costs of apportionment not otherwise paid by the owners of record of the changed parcels and an amended assessment diagram relating to the changed parcels, which Amended Diagram refers to the original recorded assessment diagram for the assessment district.

Respectfully submitted this 20th day of May 2011

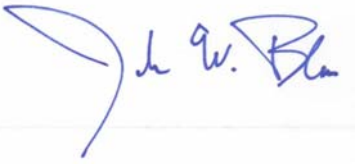
	<p>SCI Consulting Group</p>  <p>By: _____ John W. Bliss, License No. C052091</p>
---	--

**EXHIBIT A**

**MOUNTAINS RECREATION AND CONSERVATION AUTHORITY  
Santa Monica Mountains Open Space Preservation Assessment District No. 1  
Los Angeles**

Original Assessor's Parcel Numbers:	Original Assessment Amount	Unpaid Assessment	New Assessment Number	New Assessor Parcel Number(s)	Percentage of Original Assessment	Original Assessment Apportioned	Unpaid Assessment Apportioned	Cost of Apportionment	Property Owner's Name
2274-023-005	563.02	455.02	2274023033	2274-023-033	100.00 %	563.02	455.02	0.00	GRUHLKE BRANDY L
2274-026-002	281.51	227.51	2274026006	2274-026-006	100.00 %	281.51	227.51	0.00	BUCKLEY SCHOOL
2275-010-025	563.02	455.02	2275010030	2275-010-030	100.00 %	563.02	455.02	0.00	JOHNSON BLAKE & COURTNEY
2277-007-013	563.02	455.02	2277007026	2277-007-026	100.00 %	563.02	455.02	0.00	HABER GARY
2369-009-018	563.02	455.02	2369009030	2369-009-030	50.00 %	281.51	227.51	0.00	BANS JENNA F
2369-009-018	563.02	455.02	2369009031	2369-009-031	50.00 %	281.51	227.51	0.00	ROGERS JOHN P
2373-020-006	563.02	455.02	2373020016	2373-020-016	100.00 %	563.02	455.02	0.00	GOLDMAN KENNETH & MERAV
2373-022-003	563.02	455.02	2373022018	2373-022-018	50.00 %	281.51	227.51	0.00	MARMONT INVESTMENTS LLC
2373-022-003	563.02	455.02	2373022019	2373-022-019	50.00 %	281.51	227.51	0.00	MARMONT INVESTMENTS LLC
2376-015-023	563.02	455.02	2376015029	2376-015-029	100.00 %	563.02	455.02	0.00	MANSON RICHARD P & JILL Y
2384-015-041; 2384-015-042	563.02	455.02	2384015048	2384-015-048	100.00 %	563.02	455.02	0.00	KANARSH STEVEN & IGOR

**EXHIBIT A**

**MOUNTAINS RECREATION AND CONSERVATION AUTHORITY  
Santa Monica Mountains Open Space Preservation Assessment District No. 1  
Los Angeles**

Original Assessor's Parcel Numbers:	Original Assessment Amount	Unpaid Assessment	New Assessment Number	New Assessor Parcel Number(s)	Percentage of Original Assessment	Original Assessment Apportioned	Unpaid Assessment Apportioned	Cost of Apportionment	Property Owner's Name
2384-015-045	281.51	227.51	2384015049	2384-015-049	100.00 %	281.51	227.51	0.00	PRECISION DEVELOPMENT LLC
2385-004-030	563.02	455.02	2385004055	2385-004-055	50.00 %	281.51	227.51	0.00	STELL JEFFREY A
2385-004-030	563.02	455.02	2385004056	2385-004-056	50.00 %	281.51	227.51	0.00	STELL JEFFREY A
2385-009-010; 2385-009-027	844.53	682.53	2385009037	2385-009-037	100.00 %	844.53	682.53	0.00	RAPPEL MARC & PAMELA
2385-017-023	563.02	455.02	2385017027	2385-017-027	100.00 %	563.02	455.02	0.00	MENDEL NATHAN G
2385-023-027	563.02	455.02	2385023035	2385-023-035	100.00 %	563.02	455.02	0.00	LE COMTE ROGER & ELLEN
2385-023-022	563.02	455.02	2385023036	2385-023-036	100.00 %	563.02	455.02	0.00	DON CORNELIUS PRODUCTIONS INC
2385-023-028	281.51	227.51	2385023037	2385-023-037	100.00 %	281.51	227.51	0.00	LE COMTE ROGER & ELLEN
2385-027-029	563.02	455.02	2385027034	2385-027-034	100.00 %	563.02	455.02	0.00	MACARAH KAREN A
2386-004-006	563.02	455.02	2386004013	2386-004-013	100.00 %	563.02	455.02	0.00	SANEYOSHI YORIKO
2386-004-004	563.02	455.02	2386004014	2386-004-014	100.00 %	563.02	455.02	0.00	SANEYOSHI YORIKO

**EXHIBIT A**

**MOUNTAINS RECREATION AND CONSERVATION AUTHORITY  
Santa Monica Mountains Open Space Preservation Assessment District No. 1  
Los Angeles**

Original Assessor's Parcel Numbers:	Original Assessment Amount	Unpaid Assessment	New Assessment Number	New Assessor Parcel Number(s)	Percentage of Original Assessment	Original Assessment Apportioned	Unpaid Assessment Apportioned	Cost of Apportionment	Property Owner's Name
2386-005-003	563.02	455.02	2386005052	2386-005-052	100.00 %	563.02	455.02	0.00	LIBBY HALSEY R & ANGELA
2386-005-043; 2386-005-045; 2386-005-047	844.53	682.53	2386005053	2386-005-053	100.00 %	844.53	682.53	0.00	PATUSH CORPORATION
2428-003-029; 2428-003-030	844.53	682.53	2428003052	2428-003-052	100.00 %	844.53	682.53	0.00	KEATS ELE
2428-010-044	563.02	455.02	2428010045	2428-010-045	100.00 %	563.02	455.02	0.00	KRACOV DAVID
2428-010-018	281.51	227.51	2428010047	2428-010-047	100.00 %	281.51	227.51	0.00	GATEWAY BUSINESS BANK
2428-010-019	281.51	227.51	2428010048	2428-010-048	100.00 %	281.51	227.51	0.00	GATEWAY BUSINESS BANK
2428-010-020	281.51	227.51	2428010049	2428-010-049	100.00 %	281.51	227.51	0.00	GATEWAY BUSINESS BANK
2428-010-021	281.51	227.51	2428010050	2428-010-050	100.00 %	281.51	227.51	0.00	GATEWAY BUSINESS BANK
2428-010-022	281.51	227.51	2428010051	2428-010-051	100.00 %	281.51	227.51	0.00	GATEWAY BUSINESS BANK
2428-013-002	563.02	455.02	2428013019	2428-013-019	100.00 %	563.02	455.02	0.00	GREEN JAMES T
2428-028-033	281.51	227.51	2428028037	2428-028-037	100.00 %	281.51	227.51	0.00	SKRBIC LOU

**EXHIBIT A**

**MOUNTAINS RECREATION AND CONSERVATION AUTHORITY  
Santa Monica Mountains Open Space Preservation Assessment District No. 1  
Los Angeles**

Original Assessor's Parcel Numbers:	Original Assessment Amount	Unpaid Assessment	New Assessment Number	New Assessor Parcel Number(s)	Percentage of Original Assessment	Original Assessment Apportioned	Unpaid Assessment Apportioned	Cost of Apportionment	Property Owner's Name
2429-020-010; 2429-020-011	844.53	682.53	2429020025	2429-020-025	100.00 %	844.53	682.53	0.00	KIRKPATRICK J DAVY
4352-009-052	422.27	341.27	4352009054	4352-009-054	100.00 %	422.27	341.27	0.00	512 PERUGIA WAY LLC
4355-011-012; 4355-011-013	844.53	682.53	4355011045	4355-011-045	100.00 %	844.53	682.53	0.00	WEISENBERG CHARLES & RENEE
4356-008-005	281.51	227.51	4356008010	4356-008-010	100.00 %	281.51	227.51	0.00	9904 PROPERTIES INC
4356-016-024	281.51	227.51	4356016026	4356-016-026	100.00 %	281.51	227.51	0.00	THOMPSON ROBERT W
4356-016-015	563.02	455.02	4356016027	4356-016-027	100.00 %	563.02	455.02	0.00	LEMANN MONTE M & CC PULITZER
4362-009-001	563.02	455.02	4362009011	4362-009-011	100.00 %	563.02	455.02	0.00	MARYMOUNT HIGH SCHOOL LA
4362-015-006; 4362-015-007; 4362-015-008; 4362-015-020; 4370-024-017	2252.08	1820.08	4362015022	4362-015-022	100.00 %	2252.08	1820.08	0.00	ECP ACQUISITIONS LLC
4362-017-032	1126.04	910.04	4362017034	4362-017-034	50.00 %	563.02	455.02	0.00	805 NIMES PLACE LLC
4362-017-032	563.02	455.02	4362017047	4362-017-047	50.00 %	563.02	455.02	0.00	805 NIMES PLACE LLC
4362-017-026	281.51	227.51	4362017048	4362-017-048	100.00 %	281.51	227.51	0.00	805 NIMES PLACE LLC

**EXHIBIT A**

**MOUNTAINS RECREATION AND CONSERVATION AUTHORITY  
Santa Monica Mountains Open Space Preservation Assessment District No. 1  
Los Angeles**

Original Assessor's Parcel Numbers:	Original Assessment Amount	Unpaid Assessment	New Assessment Number	New Assessor Parcel Number(s)	Percentage of Original Assessment	Original Assessment Apportioned	Unpaid Assessment Apportioned	Cost of Apportionment	Property Owner's Name
4369-036-025; 4369-036-026	844.53	682.53	4369036029	4369-036-029	100.00 %	844.53	682.53	0.00	MORITZ ROLAND
2371-001-008; 2371-001-010	844.53	682.53	4371001011	4371-001-011	100.00 %	844.53	682.53	0.00	VREELAND BYRON R
4371-004-013; 4371-004-019	563.02	455.02	4371004022	4371-004-022	100.00 %	563.02	455.02	0.00	VREELAND THAIS
4377-010-018	281.51	227.51	4377010019	4377-010-019	100.00 %	281.51	227.51	0.00	TATE DAVID M & ANGELIKA
4377-017-002	563.02	455.02	4377017018	4377-017-018	100.00 %	563.02	455.02	0.00	KIM YOUNG B & JANIS L
4377-048-013; 4377-048-014	563.02	455.02	4377048019	4377-048-019	100.00 %	563.02	455.02	0.00	LACK WALTER J & BARBARA J
4380-010-028; 4380-010-029	1126.04	910.04	4380010030	4380-010-030	100.00 %	1126.04	910.04	0.00	THOROGOOD GEORGE & MARIA
4383-020-010; 4383-020-011	563.02	455.02	4383020024	4383-020-024	100.00 %	563.02	455.02	0.00	FEIZ PARASTOU
5549-021-003; 5549-021-004	686.88	555.12	5549021037	5549-021-037	100.00 %	686.88	555.12	0.00	FRANK TANYA
5556-010-011	563.02	455.02	5556010042	5556-010-042	100.00 %	563.02	455.02	0.00	MIZRAHI HEATHER
5556-025-008	563.02	455.02	5556025018	5556-025-018	100.00 %	563.02	455.02	0.00	WATERMAN JONATHAN

**EXHIBIT A**

**MOUNTAINS RECREATION AND CONSERVATION AUTHORITY  
Santa Monica Mountains Open Space Preservation Assessment District No. 1  
Los Angeles**

Original Assessor's Parcel Numbers:	Original Assessment Amount	Unpaid Assessment	New Assessment Number	New Assessor Parcel Number(s)	Percentage of Original Assessment	Original Assessment Apportioned	Unpaid Assessment Apportioned	Cost of Apportionment	Property Owner's Name
5556-007-031; 5556-025-011	563.02	455.02	5556025019	5556-025-019	100.00 %	563.02	455.02	0.00	SCHILD WALTER
5558-004-001; 5558-004-002; 5558-006-001	844.53	682.53	5558006030	5558-006-030	100.00 %	844.53	682.53	0.00	BECKER GERHARD
5558-012-023	281.51	227.51	5558012027	5558-012-027	100.00 %	281.51	227.51	0.00	WEALTHA 101 LLC
5560-021-006	563.02	455.02	5560021029	5560-021-029	100.00 %	563.02	455.02	0.00	DEBOLT CHRISTOPHER
5560-021-005	563.02	455.02	5560021030	5560-021-030	100.00 %	563.02	455.02	0.00	DUNAS JEFF
5561-019-030	1126.04	910.04	5561019033	5561-019-033	100.00 %	1126.04	910.04	0.00	RISING GLEN DEVELOPMENT PARTNERS LLC
5561-021-014	563.02	455.02	5561021031	5561-021-031	100.00 %	563.02	455.02	0.00	THOMAS JENNIFER G & GUY S
5563-015-003	563.02	455.02	5563015038	5563-015-038	100.00 %	563.02	455.02	0.00	GOLDMAN DAVID
5564-028-006	563.02	455.02	5564028031	5564-028-031	100.00 %	563.02	455.02	0.00	GIEBEN ELEONORE
5565-016-001	281.51	227.51	5565016010	5565-016-010	100.00 %	281.51	227.51	0.00	CHAFIR MAXIMILIEN
5565-028-013; 5565-028-030	844.53	682.53	5565028041	5565-028-041	100.00 %	844.53	682.53	0.00	LYDECKER GERRIT JR



**EXHIBIT A**

**MOUNTAINS RECREATION AND CONSERVATION AUTHORITY  
Santa Monica Mountains Open Space Preservation Assessment District No. 1  
Los Angeles**

Original Assessor's Parcel Numbers:	Original Assessment Amount	Unpaid Assessment	New Assessment Number	New Assessor Parcel Number(s)	Percentage of Original Assessment	Original Assessment Apportioned	Unpaid Assessment Apportioned	Cost of Apportionment	Property Owner's Name
5565-031-001; 5565-031-007	844.53	682.53	5565031014	5565-031-014	100.00 %	844.53	682.53	0.00	WEBB ERIC
5567-022-036	563.02	455.02	5567022038	5567-022-038	100.00 %	563.02	455.02	0.00	DORAN PATRICK G
5567-025-001	563.02	455.02	5567025047	5567-025-047	100.00 %	563.02	455.02	0.00	SLOANE STEPHEN M
5569-036-006; 5569-036-007; 5569-036-014	1126.04	910.04	5569036016	5569-036-016	100.00 %	1126.04	910.04	0.00	ITZHAKI AVITAL
5570-006-006	563.02	455.02	5570006021	5570-006-021	100.00 %	563.02	455.02	0.00	TOWNSEND CLAYTON
5570-036-004	563.02	455.02	5570036018	5570-036-018	100.00 %	563.02	455.02	0.00	STOLL BOBBI
5570-038-007; 5570-038-008	1126.04	910.04	5570038029	5570-038-029	100.00 %	1126.04	910.04	0.00	FOGEL ARTHUR
5571-001-022; 5571-001-023	844.53	682.53	5571001027	5571-001-027	100.00 %	844.53	682.53	0.00	POLLEKOFF DALE J
5572-029-057	1216.12	982.84	5572029058	5572-029-058	15.74 %	191.42	154.70	0.00	1823 N FULLER AVE II LLC
5572-029-057	1216.12	982.84	5572029059	5572-029-059	15.74 %	191.42	154.70	0.00	1823 N FULLER AVE II LLC
5572-029-057	1216.12	982.84	5572029060	5572-029-060	15.74 %	191.42	154.70	0.00	1823 N FULLER AVE II LLC

**EXHIBIT A**

**MOUNTAINS RECREATION AND CONSERVATION AUTHORITY  
Santa Monica Mountains Open Space Preservation Assessment District No. 1  
Los Angeles**

Original Assessor's Parcel Numbers:	Original Assessment Amount	Unpaid Assessment	New Assessment Number	New Assessor Parcel Number(s)	Percentage of Original Assessment	Original Assessment Apportioned	Unpaid Assessment Apportioned	Cost of Apportionment	Property Owner's Name
5572-029-057	1216.12	982.84	5572029061	5572-029-061	15.74 %	191.42	154.70	0.00	1823 N FULLER AVE II LLC
5572-029-057	1216.12	982.84	5572029062	5572-029-062	15.74 %	191.42	154.70	0.00	1823 N FULLER AVE II LLC
5572-029-057	1216.12	982.84	5572029063	5572-029-063	21.30 %	259.03	209.34	0.00	1823 N FULLER AVE II LLC
5579-019-016	281.51	227.51	5579019036	5579-019-036	100.00 %	281.51	227.51	0.00	BARHAM PROPERTIES LLC

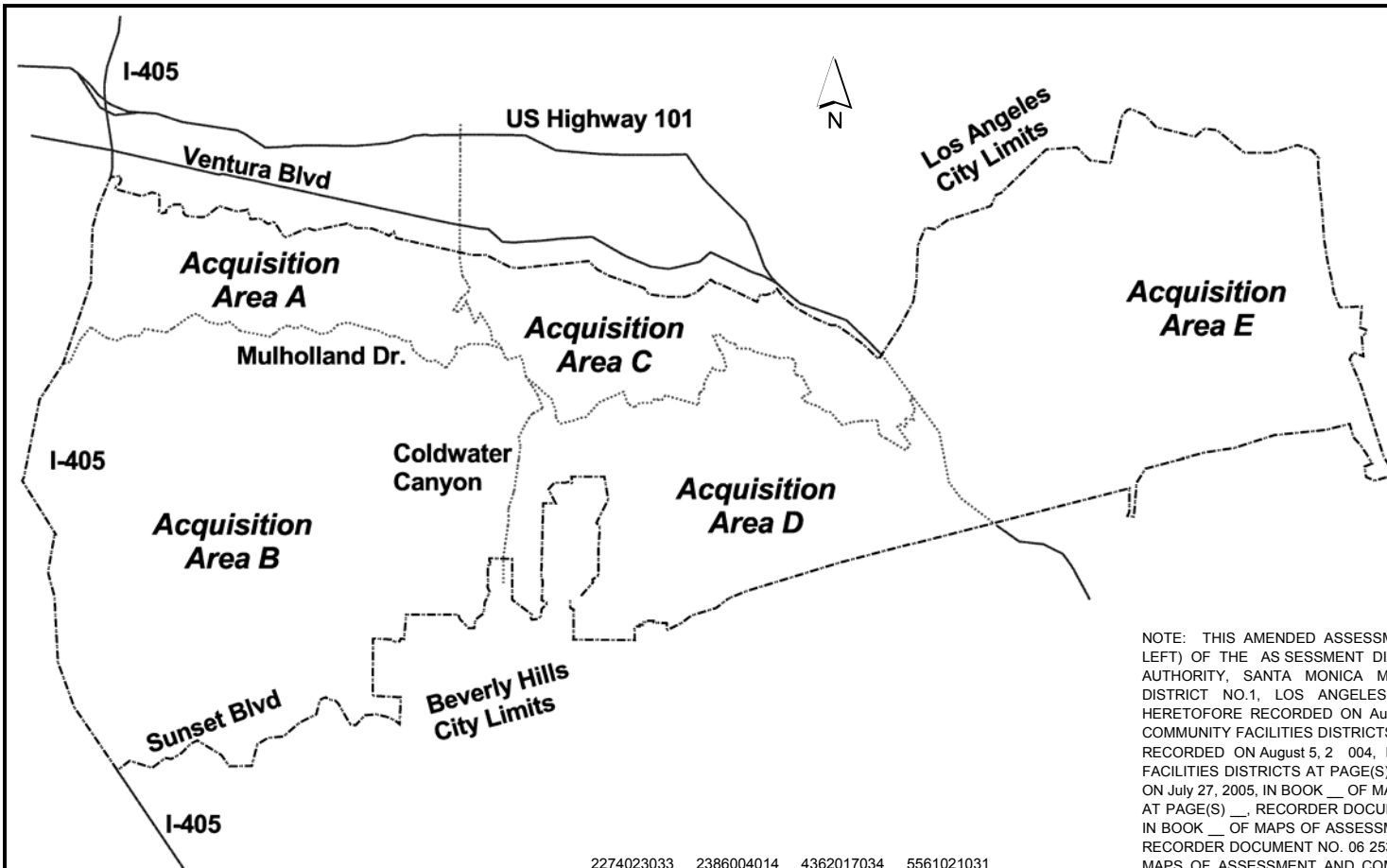

FILED IN THE OFFICE OF THE SECRETARY OF THE MOUNTAINS RECREATION AND CONSERVATION AUTHORITY THIS \_\_\_\_ DAY OF \_\_\_\_\_, 2011.

SECRETARY, MOUNTAINS RECREATION AND CONSERVATION AUTHORITY

RECORDED IN THE OFFICE OF THE ENGINEER OF MOUNTAINS RECREATION AND CONSERVATION AUTHORITY, THIS \_\_\_\_ DAY OF \_\_\_\_\_, 2011.

ENGINEER, MOUNTAINS RECREATION AND CONSERVATION AUTHORITY

FILED THIS \_\_\_\_ DAY OF \_\_\_\_\_, 2011, AT THE HOUR OF \_\_\_\_ O'CLOCK \_\_\_\_ M., IN BOOK \_\_\_\_ OF MAPS OF ASSESSMENT AND COMMUNITY FACILITIES DISTRICTS AT PAGE(S) \_\_\_\_ IN THE OFFICE OF THE COUNTY RECORDER OF THE COUNTY OF LOS ANGELES, STATE OF CALIFORNIA.

COUNTY RECORDER, COUNTY OF LOS ANGELES

BY \_\_\_\_\_, DEPUTY

NOTE: THIS AMENDED ASSESSMENT DIAGRAM AMENDS ASSESSMENT NO(S).(SEE LIST TO LEFT) OF THE ASSESSMENT DIAGRAM OF MOUNTAINS RECREATION AND CONSERVATION AUTHORITY, SANTA MONICA MOUNTAINS OPEN SPACE PRESERVATION ASSESSMENT DISTRICT NO.1, LOS ANGELES, COUNTY OF LOS ANGELES, STATE OF CALIFORNIA, HERETOFORE RECORDED ON August 13, 2003, IN BOOK \_\_\_\_ OF MAPS OF ASSESSMENT AND COMMUNITY FACILITIES DISTRICTS AT PAGE(S) \_\_\_, RECORDER DOCUMENT NO. 03 2342862 AND RECORDED ON August 5, 2004, IN BOOK \_\_\_\_ OF MAPS OF ASSESSMENT AND COMMUNITY FACILITIES DISTRICTS AT PAGE(S) \_\_\_, RECORDER DOCUMENT NO. 04 2019910 AND RECORDED ON July 27, 2005, IN BOOK \_\_\_\_ OF MAPS OF ASSESSMENT AND COMMUNITY FACILITIES DISTRICTS AT PAGE(S) \_\_\_, RECORDER DOCUMENT NO. 05 17 83696 AND RECORDED ON November 15, 2006, IN BOOK \_\_\_\_ OF MAPS OF ASSESSMENT AND COMMUNITY FACILITIES DISTRICTS AT PAGE(S) \_\_\_, RECORDER DOCUMENT NO. 06 2534570 AND RECORDED ON December 17, 2007, IN BOOK \_\_\_\_ OF MAPS OF ASSESSMENT AND COMMUNITY FACILITIES DISTRICTS AT PAGE(S) \_\_\_, RECORDER DOCUMENT NO. 20072767504 AND RECORDED ON September 10, 2008, IN BOOK \_\_\_\_ OF MAPS OF ASSESSMENT AND COMMUNITY FACILITIES DISTRICTS AT PAGE(S) \_\_\_, RECORDER DOCUMENT NO. 20081631981 AND RECORDED ON February 4, 2010, IN BOOK \_\_\_\_ OF MAPS OF ASSESSMENT AND COMMUNITY FACILITIES DISTRICTS AT PAGE(S) \_\_\_, RECORDER DOCUMENT NO. 20100150386 INCLUSIVE IN THE OFFICE OF THE COUNTY RECORDER OF THE COUNTY OF LOS ANGELES, STATE OF CALIFORNIA AND RECORDED ON December 13, 2010, IN BOOK \_\_\_\_ OF MAPS OF ASSESSMENT AND COMMUNITY FACILITIES DISTRICTS AT PAGE(S) \_\_\_, RECORDER DOCUMENT NO. 20101840824 INCLUSIVE IN THE OFFICE OF THE COUNTY RECORDER OF THE COUNTY OF LOS ANGELES, STATE OF CALIFORNIA.

**AMENDED ASSESSMENT DIAGRAM NO. 8  
AMENDING ASSESSMENT NO(S).(SEE LIST TO LEFT)  
MOUNTAINS RECREATION AND CONSERVATION AUTHORITY  
Santa Monica Mountains Open Space Preservation  
Assessment District No. 1, Los Angeles  
County of Los Angeles, State of California**

- LEGEND**
- Assessment District Boundaries
  - Major Roads & Highways
  - Acquisition Area Boundaries

2274023033	2386004014	4362017034	5561021031
2274026006	2386005052	4362017047	5563015038
2275010030	2386005053	4362017048	5564028031
2277007026	2428003052	4369036029	5565016010
2369009030	2428010045	4371001011	5565028041
2369009031	2428010047	4371004022	5565031014
2373020016	2428010048	4377010019	5567022038
2373022018	2428010049	4377017018	5567025047
2373022019	2428010050	4377048019	5569036016
2376015029	2428010051	4380010030	5570006021
2384015048	2428013019	4383020024	5570036018
2384015049	2428028037	5549021037	5570038029
2385004055	2429020025	5556010042	5571001027
2385004056	4352009054	5556025018	5572029058
2385009037	4355011045	5556025019	5572029059
2385017027	4356008010	5558006030	5572029060
2385023035	4356016026	5558012027	5572029061
2385023036	4356016027	5560021029	5572029062
2385023037	4362009011	5560021030	5572029063
2385027034	4362015022	5561019033	5579019036
2386004013			

SCI Consulting Group  
4745 Mangels Blvd  
Fairfield, CA 94534  
(707) 430-4300